

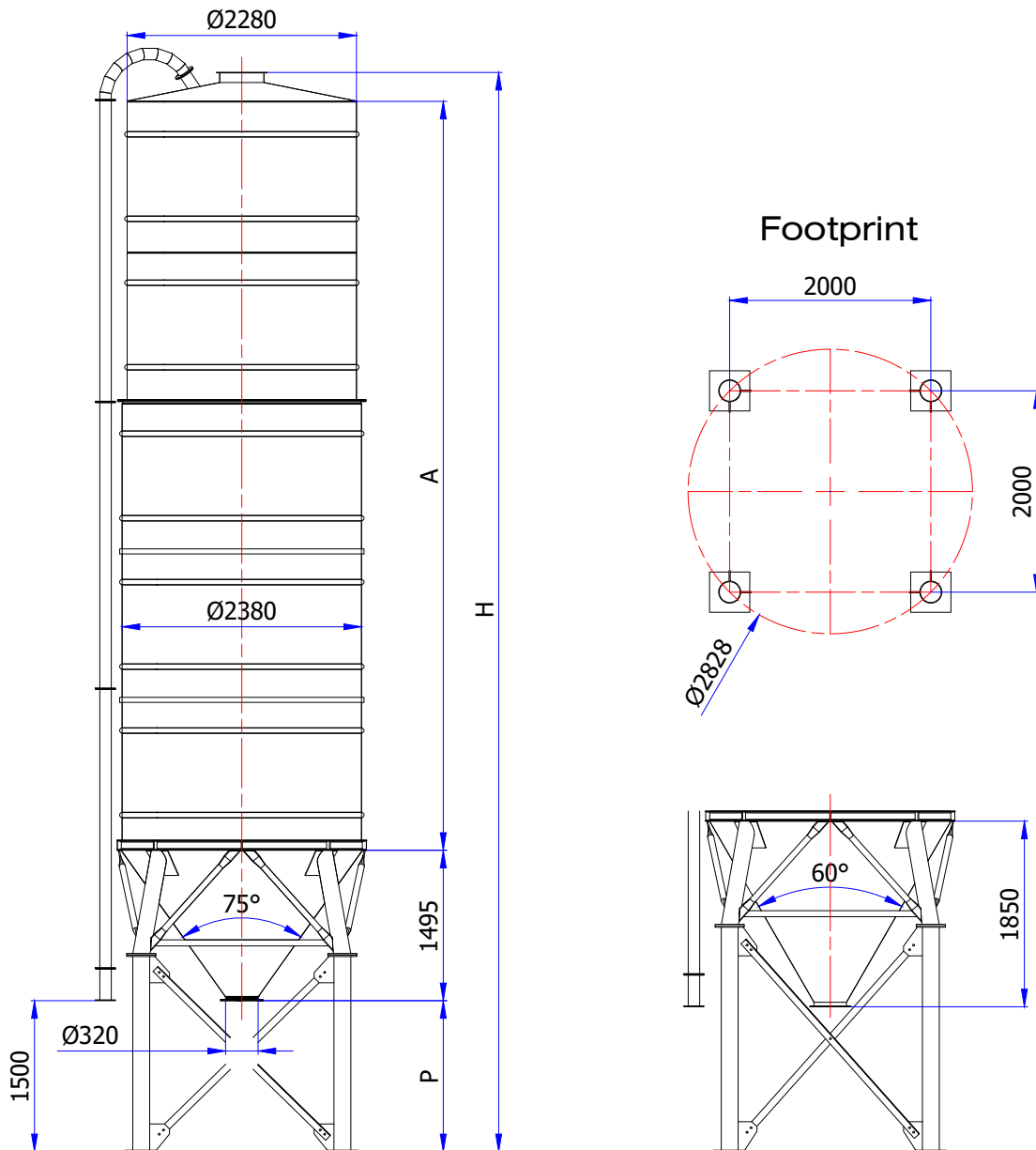

Type	Capacity		P (mm)	A (mm)	H (mm)	
	m ³ (1)	ton (2)			cone 75°	cone 60°
ST30	29	40	1500	6000	9195	9550
ST37	36	50	1500	7500	10695	11050
ST43	42	60	1500	9000	12195	12550
ST50	50	70	1500	10500	13695	14050
ST55	55	77	1500	12000	15195	15550
ST61	60	85	1500	13500	16695	17050
ST68	68	95	1500	15000	18195	18550

1 Capacity referred to silo's geometric volume

2 Weight referred to Cement bulk density of 1.4 ton/m³



Authorised Distributor: