

- 1. BELT WIDTH : 0900mm
- 2. FRAME : HOT DIP GALVANIZED
- 3. ROLLER : PAINTED BLUE (RAL5002)
- 4. BEARING TYPE : 6305ZZ C3

FABRICATION TOLERANCES UNO	
ANGULAR	± 0.5°
FLATNESS	± 2.0 PER 1000
LINER DIM	DEVIATION
0-6	± 0.3
6-30	± 0.5
30-120	± 0.8
120-315	± 1.2
315-1000	± 2.0
1000-2000	± 3.0
2000-4000	± 4.0
SURFACE TEXTURE	6.3/√

ROLLER	90-ROL-6-0009
FRAME	90-FRM-6-0009
DESCRIPTION	PART NUMBER

REV	A	ISSUED FOR REVIEW	PCO	DRAWN	CHK'D	APP'D	DATE
-----	---	-------------------	-----	-------	-------	-------	------

CLIENT:	-
PROJECT:	-
TRANSMIN NO:	-

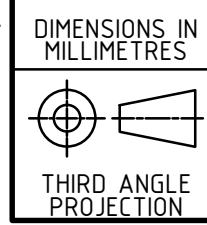

COPYRIGHT © THIS DRAWING IS THE PROPERTY OF TRANSMIN PTY LTD FOR WHICH WE RESERVE ALL RIGHTS INCLUDING THOSE RELATING TO PATENTS OR REGISTERED DESIGNS. IT MUST NOT BE REPRODUCED USED OTHERWISE OR MADE AVAILABLE TO ANY THIRD PARTY WITHOUT PRIOR PERMISSION IN WRITING.

TITLE  
**IDLER- 0900BW SERIES - ICP25**  
**35 DEG 3 ROLL**  
**CARRY ROLLER Ø127x333Fx25SD**

SCALE NTS	DRAWN:	DATE:
SIZE	CHECKED:	DATE:
NAV	APPROVED:	DATE:
DRAWING NO.		
<b>90-IDR-6-0009</b>		<b>1 OF 1</b>
		<b>A3</b>