

- 1. BELT WIDTH : 0600mm
- 2. FRAME : HOT DIP GALVANIZED
- 3. ROLLER : PAINTED BLUE (RAL5002)
- 4. BEARING TYPE : 6204ZZ C3

FABRICATION TOLERANCES UNO	
ANGULAR	± 0.5°
FLATNESS	± 2.0 PER 1000
LINEAR DIM	DEVIATION
0-6	± 0.3
6-30	± 0.5
30-120	± 0.8
120-315	± 1.2
315-1000	± 2.0
1000-2000	± 3.0
2000-4000	± 4.0
SURFACE TEXTURE	6.3/√

ROLLER	90-ROL-6-0019
FRAME	90-FRM-6-0019
DESCRIPTION	PART NUMBER

A	ISSUED FOR REVIEW					
REV	DESCRIPTION	PCO	DRAWN	CHK'D	APP'D	DATE

CLIENT:	-
PROJECT:	-
TRANSMIN NO:	-

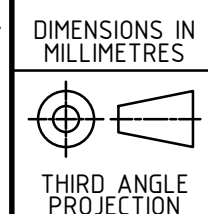

COPYRIGHT © THIS DRAWING IS THE PROPERTY OF TRANSMIN PTY LTD FOR WHICH WE RESERVE ALL RIGHTS INCLUDING THOSE RELATING TO PATENTS OR REGISTERED DESIGNS. IT MUST NOT BE REPRODUCED USED OTHERWISE OR MADE AVAILABLE TO ANY THIRD PARTY WITHOUT PRIOR PERMISSION IN WRITING.

TITLE  
 IDLER- 0600BW SERIES - OCP12  
 35 DEG 3 ROLL CARRY OFFSET  
 CARRY ROLLER Ø127x226Fx20SD

SCALE NTS	DRAWN:	DATE:
SIZE	CHECKED:	DATE:
NAV	APPROVED:	DATE:
DRAWING NO. 90-IDR-6-0019		1 OF 1 A3